

MITI

NAVI





Summary



MITI NAVI	05
S/Y MITI one 34m	11
S/Y MitiK 50m	35
Contact	56



Passionate for the sea



From anchorages to anchorages, according to the miles travelled, after having experienced all the styles of boats, we have made a synthesis and created the sailboats of our dreams.

since always.



Another idea of life at sea

Our will is naturally oriented towards the sail which remains the most ecological. But when the wind is capricious, the journey cannot stop, because our daily life has its demands.

We have equipped our ships with hybridization technological development, both for propulsion (sail and engine) than for energy (generators and photovoltaic). We imagined energy efficient ships.

MITI
NAVI

This life at sea is
available on

26

34

42

50

meters

These new sailing yachts combine the renowned know-how of shipyards traditional Turkish to European standards of the Yachting industry in engineering, construction management, equipment, and interior design.

Huge dedicated outdoor beds to relaxation and contemplation. Absolute comfort, in a refined interior, entirely made to measure and to your liking, by craftsmen of great value.

The MITI ONE 34m is already well advanced :
delivery scheduled for june 2021

The MITIK 50m is under construction :
available from winter 2021/2022

MITI ONE



MITI One 34m offers a volume impressive 198GT and will accommodate 11 passengers in five cabins, with a crew of 4 to 6 peoples.

The guests enter the boat from the huge rear platform. Exterior decks are spacious, welcoming.

They give directly onto a volume bright interior: large living room, dining room and bar. The cabins comfortable, all equipped with bathrooms, take place in the spacious and pleasant part of the hull.

MITI ONE





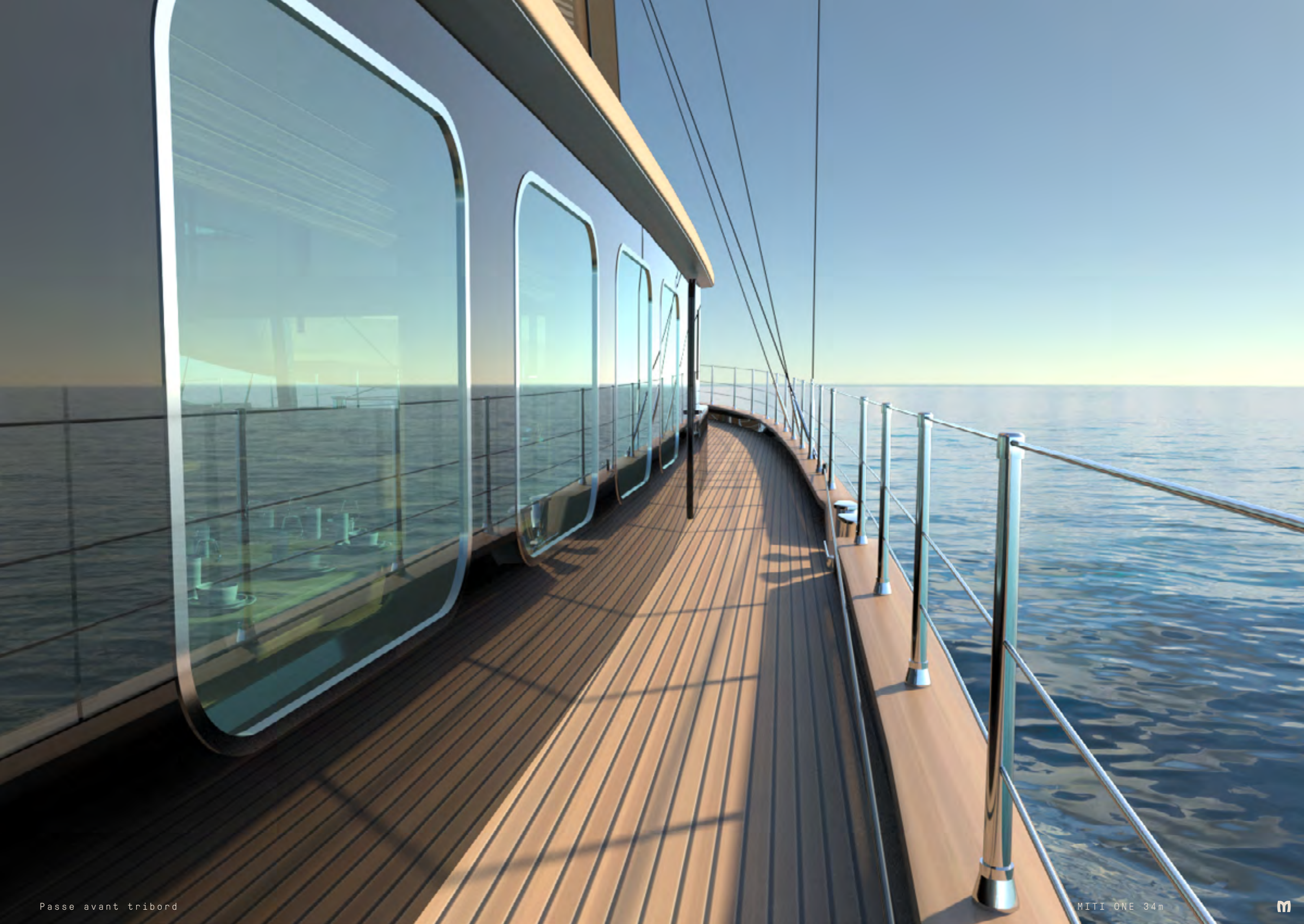



The aft deck accommodates a second dining room, shaded and comfortable, near a huge 5m bed.

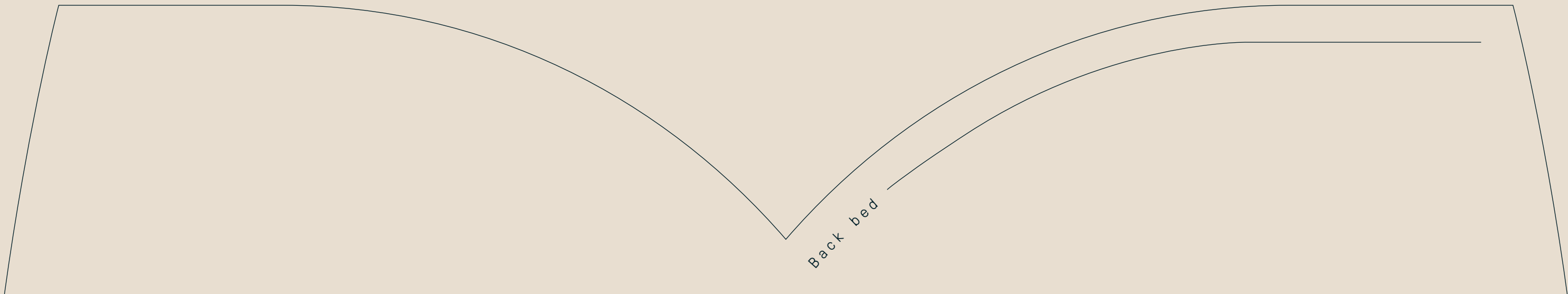

Front bed



Another huge bed is located at the front of the ship, to enjoy gentle sailing.

On board ... spaces interior
and exterior vast,

comfortable,

luminous...

Master bedroom - Bed 2m



Master bedroom - Bed 2m



Double bedroom - King Size bed



Double bedroom - 2 beds 90cm



Guest bathroom

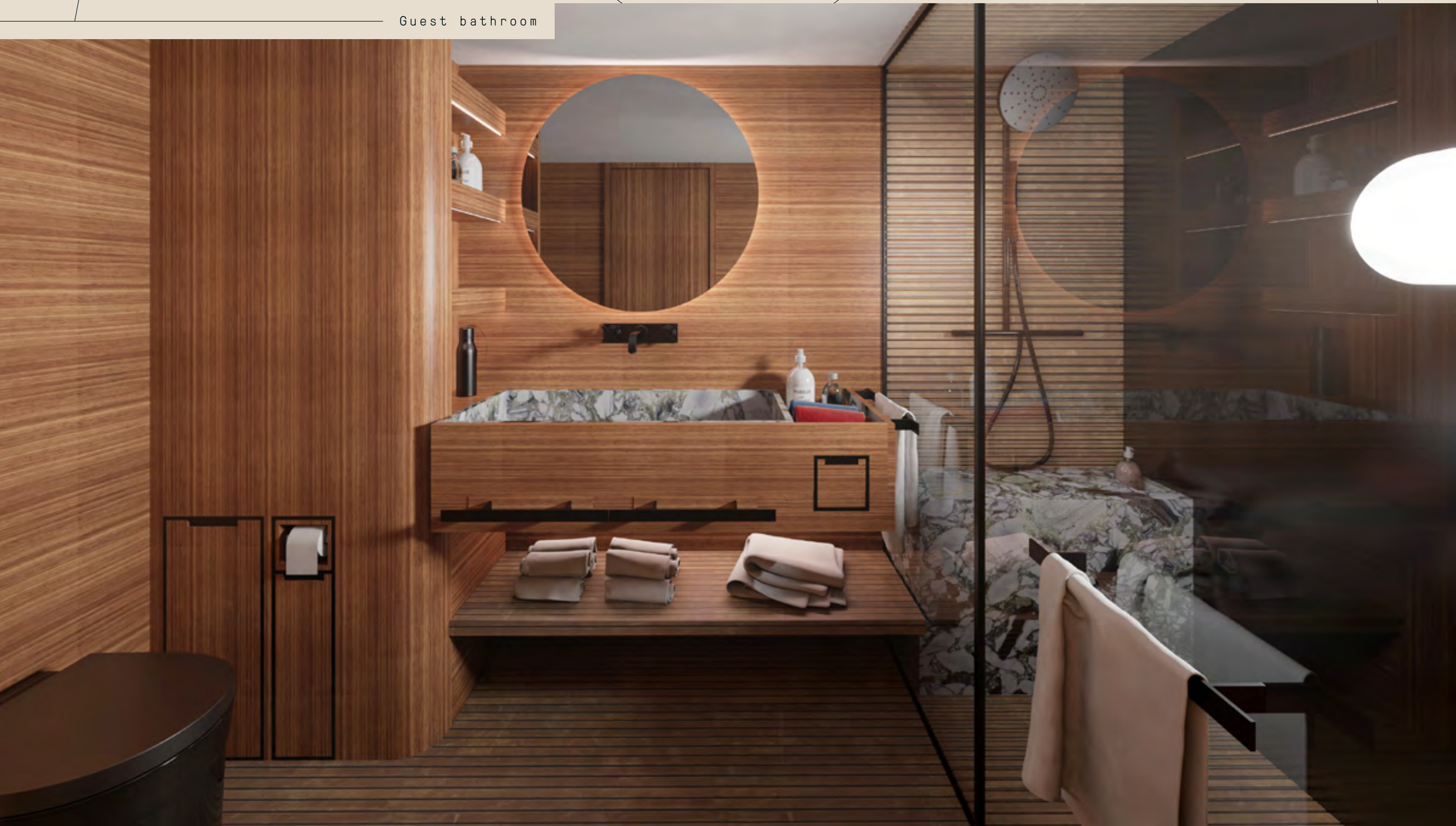

Walnut,
oak,
teak,
marble,
white,
or black?

What do you prefer ?



Living room



Living room



Kitchen



The crew has not been forgotten.
It's comfort and the quality of work
equipment, are pledged harmony
on board.



We want our MITI-NAVI
philosophy either the promise
of a dream, yours and ours, so
different from others.

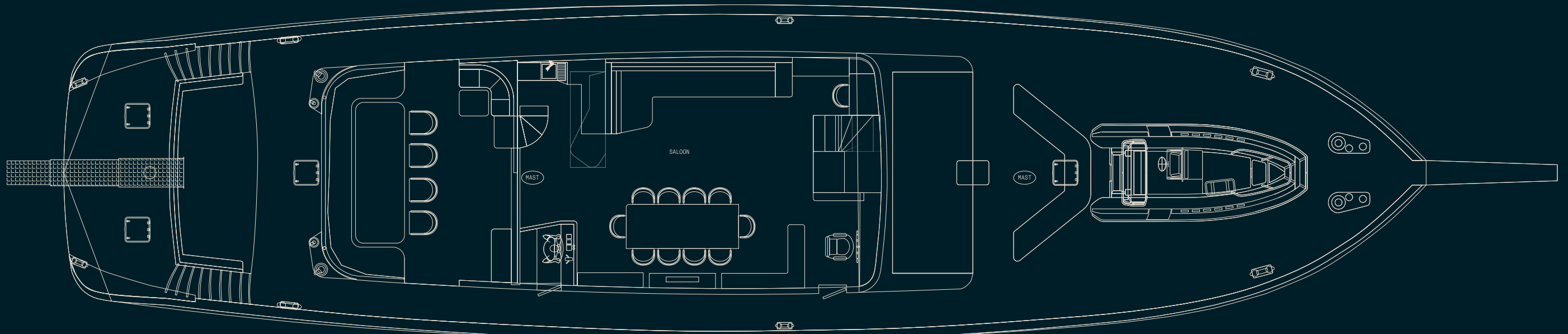
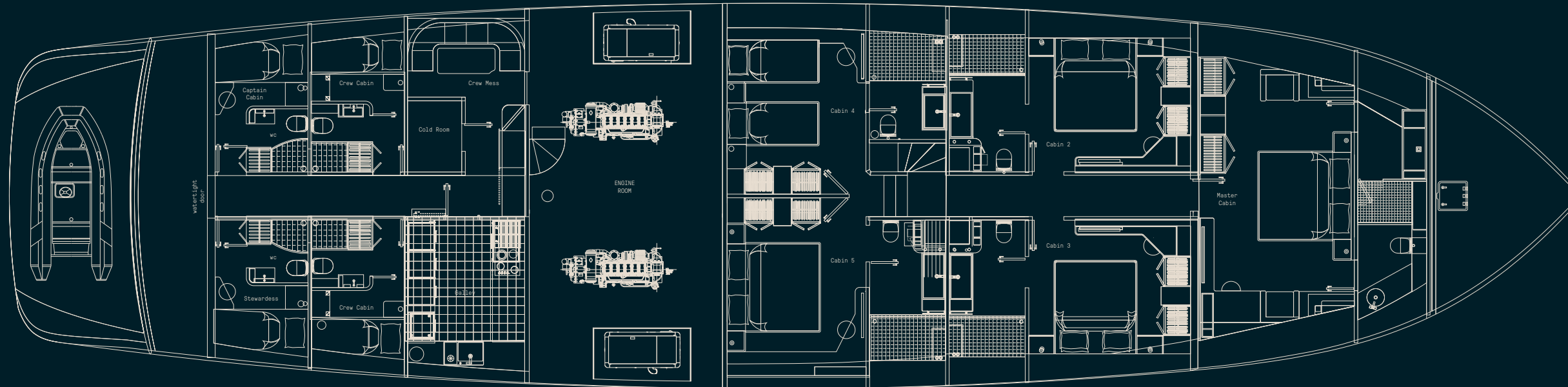

A certified unit by RINA in
yacht commercial and approved
unrestricted navigation:

Two huge beds 5m
outside Each.

2 diesel engines from 450
hp to the latest emission
standards, for cruising
speed of 11 knots (13.5
knots max)

Worthy technology of
the most prestigious
Motor-Yachts, but
simple, rational,
to maintenance
mastered...

540 m2 of sails for
honourable cruising
speed at all headings.

A certified unit by RINA in
yacht commercial and approved
unrestricted navigation:

Efficient Solar panels,
allowing silence and
quiet at anchor.

Autonomy
in water
and in energy,

Exigent standards
of soundproofing
and vibrations.

Absolute comfort, in
a refined interior,
entirely made to
measure and to your
taste, by valuable
craftsmen.

MITI ONE 34m (SPECIFICATIONS)

Main characteristics

LOA	111,75ft
LWL	102,46ft
BEAM	27,56ft
DRAFT	9,81ft
GROSS TONNAGE	198GT
SAILS	540m ² (Prisma sails)
2 ALUMINIUM MASTS	
ENGINES	2x450HP Baudouin P2 (Heavy Duty)
GENSETS	2x45kW KOHLER (Low sound level)
WATER MAKERS	2x350l/hour Delfin 7000
SOLAR PANELS	4,5kW
SEWAGE WATER TREATMENT	Hamman System

2 TENDERS

Capacities

FUEL	3950 US.gal
WATER TANK	2020 US.gal
GREY WATER	1981 US.gal
BLACK WATER	658 US.gal

2 ENGINES	
MAX SPEED	13 knots
CRUISE SPEED	11 knots
ECONOMIC SPEED	9,5 knots
RANGE	> 2000mn

PASENGERS	11
CREW	4 to 6

CABINS & ACCOMODATIONS	1 Master cabin 4 Guests cabins 4 Crew cabins with bathrooms Main Saloon 50m ² Swimming Platform 13,5m ² Multimedia
------------------------	---

RULES & CERTIFICATION	Clasification Society RINA Class Flag : Malta Commercial Unrestricted navigation
-----------------------	--

MITI ONE

MITIK













On board ...
a charm emerges:
Luxury,

elegance,

minimalist design.

Master bedroom - Bed 2m



Master Bedroom - Bed 2m



Master bathroom with steam bath

MITIK



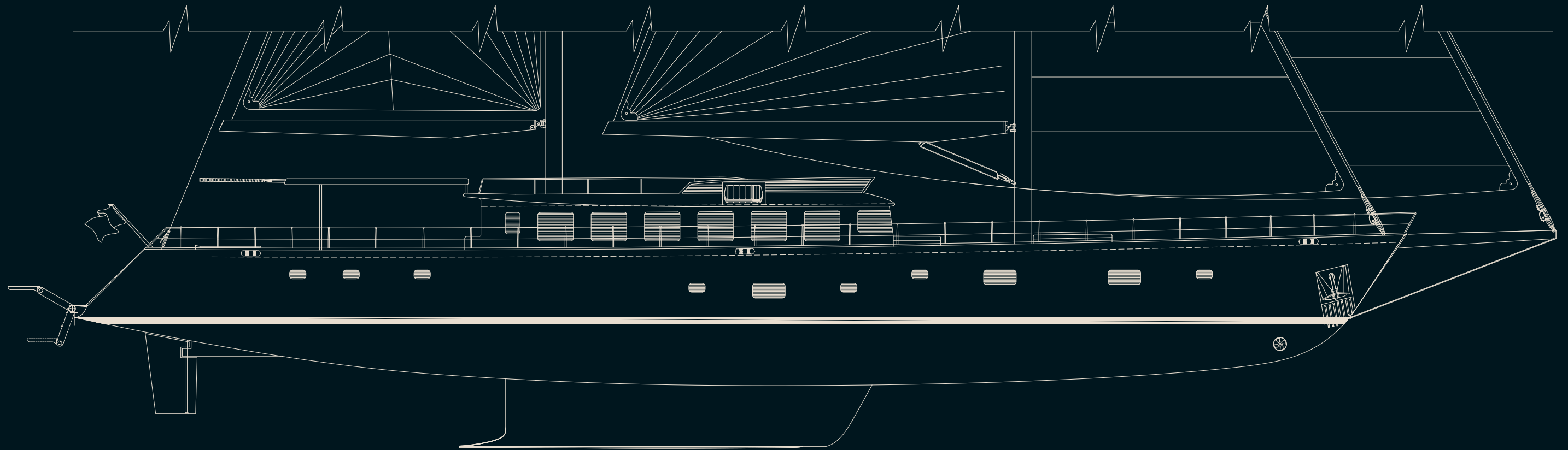

MITI K 50m

Currently under construction in the Oguz Marin Shipyard of Bodrum in Turkey, the S/Y MITI NAVI are beautiful steel hulls. Adapted to trans-oceanic navigation, they meet the RINA Classification standards. The superstructures are in steel (24m-34m), or in aluminium (42m- 50m).





Maximum speed: 14.5 Knots
 Cruising speed: 11.5 knots.

The rear deck of 28m² is reachable by the bridge or directly from the cabins; a passage privileged exists between passenger cabins and swim platform that takes you through the room machines you can see it work through windows in allow glass.

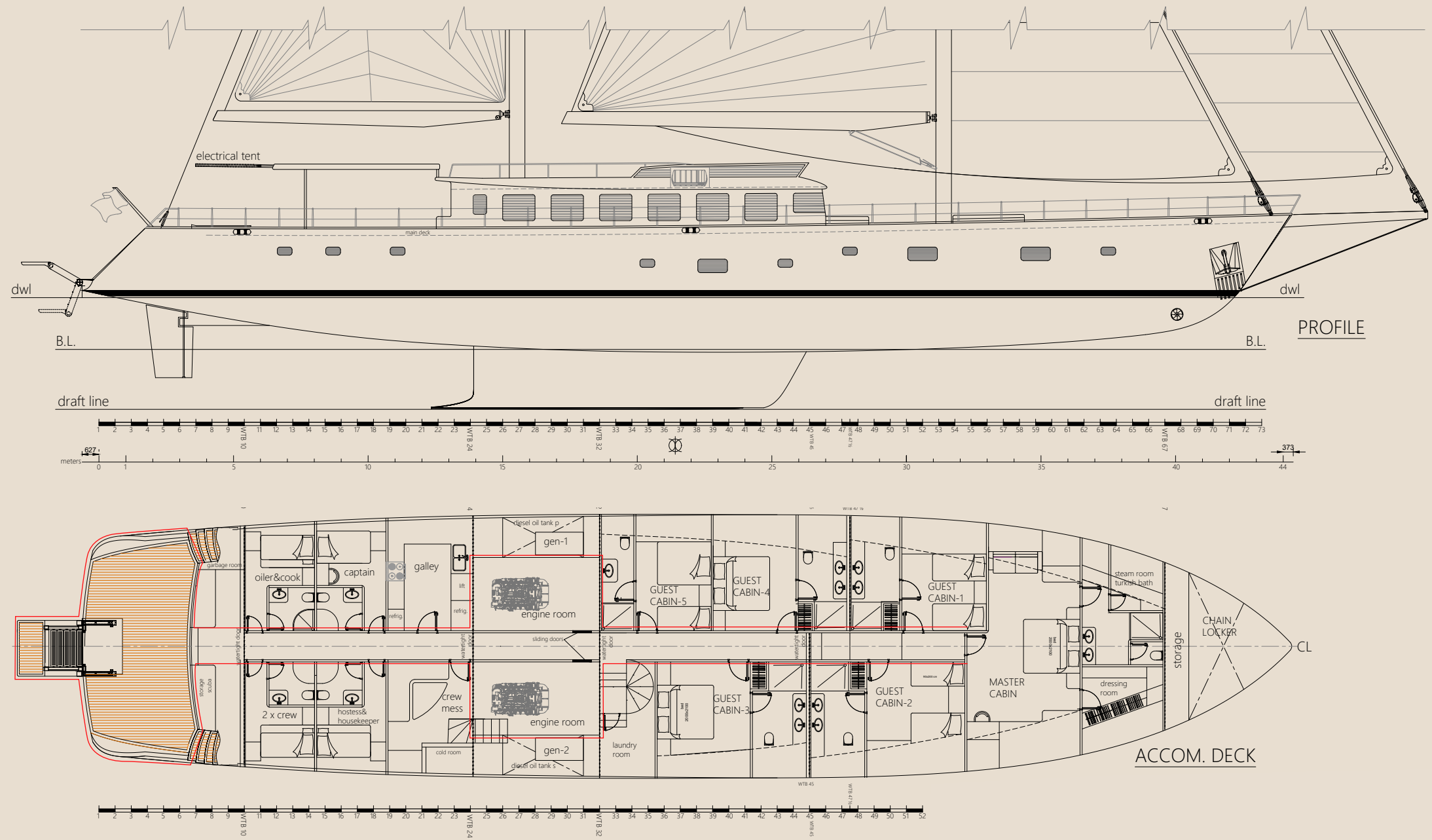

The living room makes 96m² and 13m long. The rear lounge was designed at the same level. From this place you have a clear view from inside on 17m.

The boat has six cabins. The Shipowner cabin is 50m². It houses a dressing room and a bathroom with steam bath. You there also find five double rooms as well as a laundry

In cabins, portholes have been positioned so that the outside is visible for a seated passenger. They measure 110cm by 50cm.

The rear of the boat has been reserved for the crew. We find their 4 cabins there which welcome up to 7 crew members, as well as a mess and a kitchen.

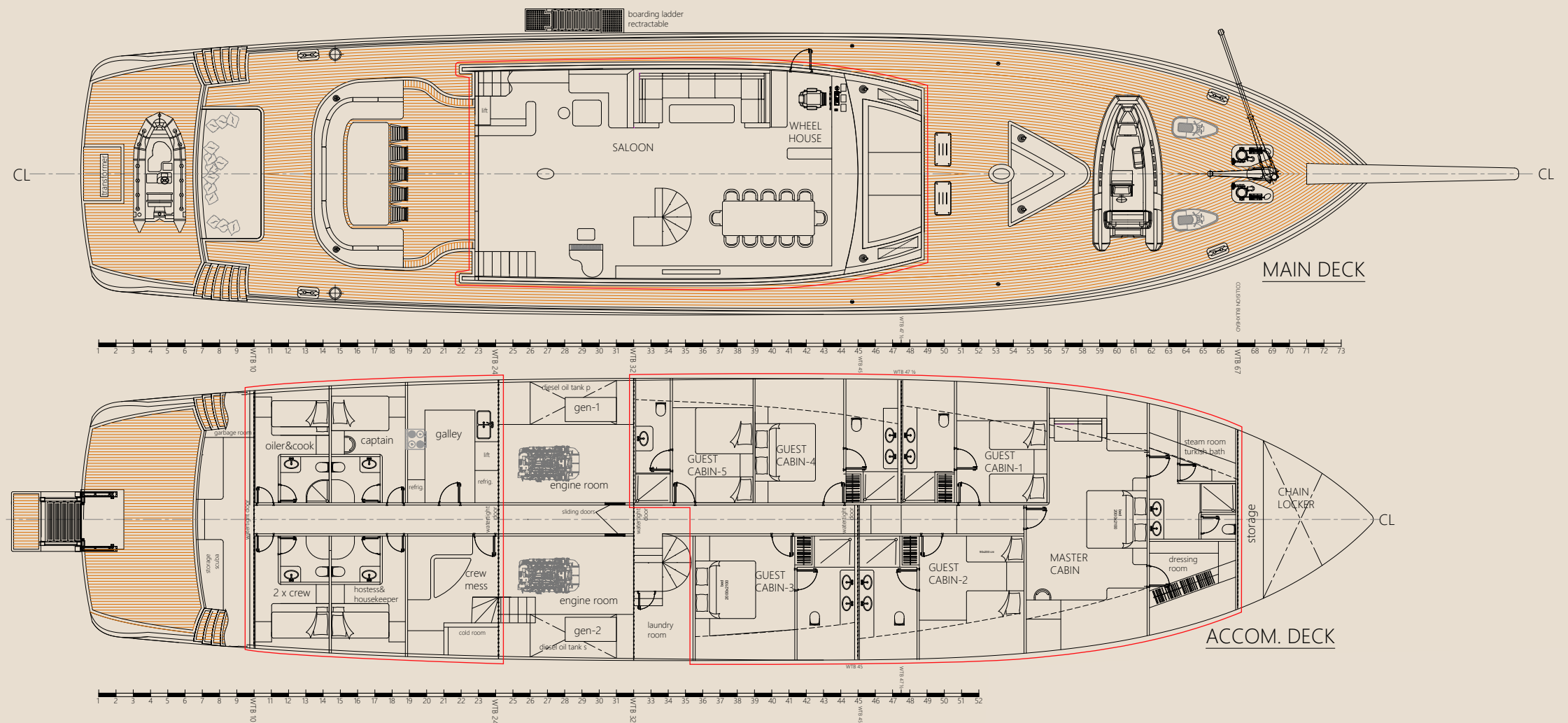

The Flying bridge above of the living room measures 94m². We relax in a Jacuzzi.

This fly includes a zone intended for sheltered fitness training and sports equipment.

You can also find a table for 12 people, one space comfortable and friendly near the pilot station, a 3rd bed where lie down, without forgetting a bar and, for one use ease, a freight elevator which serves the 3 levels of the boat.

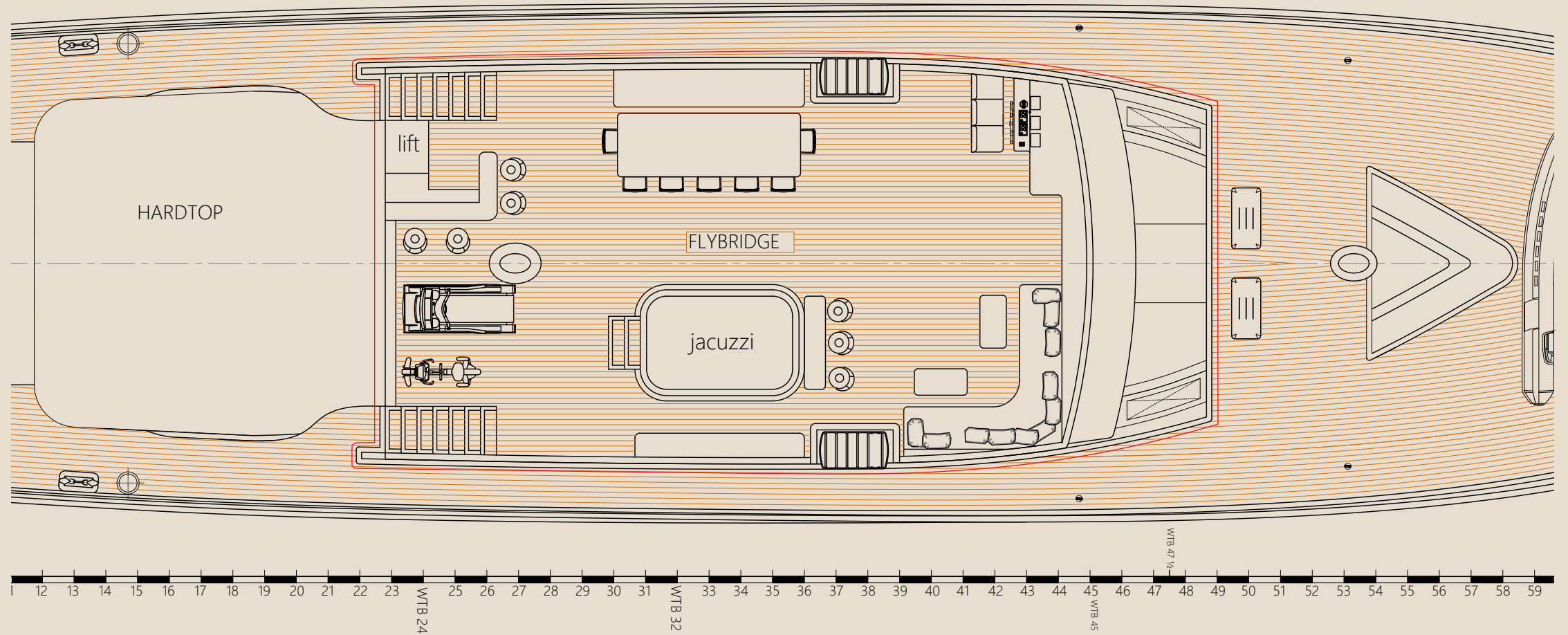



MITI K 50m (SPECIFICATIONS)

Main characteristics

LOA	165,68ft
LWL	147,63ft
BEAM	32,25ft
DRAFT	14,10ft
GROSS TONNAGE	370GT
SAILS	860m ² (Prisma sails)
2 ALUMINIUM MASTS	
ENGINES	2 Baudouin 815 HP
GENSETS	2x50kW (ONAN)
WATER MAKERS	2x350l/hour Delfin 7000
SOLAR PANELS	4,5kW
SEWAGE WATER TREATMENT	Hamman System

2 TENDERS

Capacities

FUEL	6340 US.gal
WATER TANK	6241 US.gal
GREY WATER	3170 US.gal
BLACK WATER	1157 Us.gal

2 ENGINES

MAX SPEED	14,5 knots
CRUISE SPEED	11,5 knots
ECONOMIC SPEED	10 knots
RANGE	> 2000mn

PASENGERS	12
CREW	6 to 7

CABINS & ACCOMODATIONS	1 Master cabin 6 Guests cabins 4 Crew cabins with bathrooms Flying-bridge 94m ² and Jacuzzi 6m ² Main Saloon 96m ² Swimming Platform 28m ² Multimedia
------------------------	---

RULES & CERTIFICATION	Clasification Society RINA Class Flag : Malta Commercial Unrestricted navigation
-----------------------	--

MITIK



There is nothing more beautiful
than the moment before the journey,
the moment when the horizon of
tomorrow comes to visit us.

Milan Kundera



MITI ONE

Mr Mark Seaton
sales@miti-navi.com

MITI NAVI Limited
136, St Christopher Street
Valletta VLT 1463
MALTE

miti-navi.com

[Twitter](#)

[Facebook](#)

[Youtube](#)

MITI NAVI Sales Office
Port Camille Rayon
Quai Napoléon
06220 Golfe-Juan
FRANCE



m